

The bearing and distances
down Keli are

- 1 S36W 21
 - 2 S56W 40
 - 3 S41W 32 1/2
 - 4 S63W 12 1/4
 - 5 S62W 33
 - 6 N35W 61
 - 7 N78W 25 1/2
 - 8 S72W 24
 - 9 S53W 11 1/4
 - 10 N18W 20
 - 11 S10E 14 1/2
 - 12 S5E 17
 - 13 S70W 13
- 457 1/2

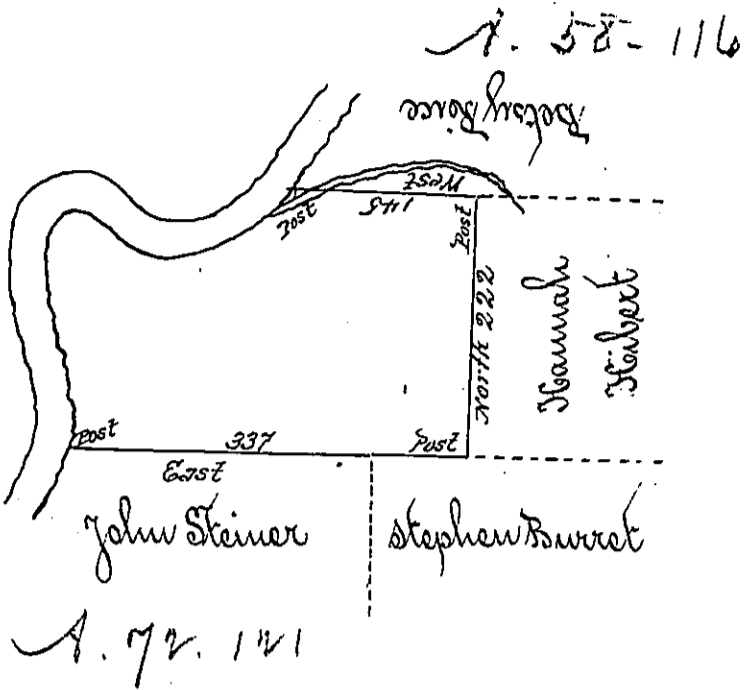

By Virtue of a Warrant dated the 5th April 1792 surveyed the 14th September 1793. to
Joachim Wignam the above described tract of land situate on the East side of Keli in the
County of Northampton. Containing four hundred and six acres and an half with the
allowance of six per cent for

To Daniel Broadhead Esq. }
Surveyor General

P Geo Palmer D.S.

IN TESTIMONY that the above is a copy of the original remaining on file in
the Department of Internal Affairs of Pennsylvania, made
conformably to an Act of Assembly approved the 16th day of
February, 1833, I have hereunto set my Hand and caused
the Seal of said Department to be affixed at Harrisburg,
this seventh day of February 1901

James W. Pitta
Secretary of Internal Affairs.